

- ALL LEGEND
- P1
 - P2
 - P3
 - P4
 - P5
 - P6
 - P7

GENERAL NOTES

1. THE GENERAL CONTRACTOR IS RESPONSIBLE FOR THE PROTECTION OF ALL EXISTING UTILITIES AND SHALL DO ALL CUTTING, PATCHING & MAKE GOOD AS NECESSARY TO MAINTAIN THE WORK OF THE SUB CONTRACTORS. THE CONTRACTOR SHALL BE RESPONSIBLE FOR THE PROTECTION OF ALL EXISTING WORK.
2. IF AN ITEM IS NECESSARY FOR THE INSTALLATION & PROTECTION OF THE WORK, THE CONTRACTOR SHALL NOTIFY THE ARCHITECT BEFORE PROCEEDING.
3. THE CONTRACTOR SHALL BE RESPONSIBLE FOR THE PROTECTION OF ALL EXISTING WORK AND SHALL BE RESPONSIBLE FOR THE PROTECTION OF ALL EXISTING UTILITIES.
4. IT IS IMPERATIVE THAT THE CONTRACTOR VERIFY ALL ON SITE CONDITIONS AND CONDITIONS AS SHOWN ON DRAWINGS ARE APPROXIMATE. THE CONTRACTOR SHALL BE RESPONSIBLE FOR THE PROTECTION OF ALL EXISTING WORK AND SHALL BE RESPONSIBLE FOR THE PROTECTION OF ALL EXISTING UTILITIES.
5. ALL NOTED EXISTING DOORS, EQUIPMENT, ETC. REMOVED DURING CONSTRUCTION IS TO REMAIN THE PROPERTY OF THE OWNER AND SHALL BE REMOVED WITH EXTREME CARE & AT ALL TIMES TO BE PROTECTED BY THE CONTRACTOR. THE CONTRACTOR SHALL BE RESPONSIBLE FOR THE PROTECTION OF ALL EXISTING WORK AND SHALL BE RESPONSIBLE FOR THE PROTECTION OF ALL EXISTING UTILITIES.
6. DISPOSE OF EXHAUSTED MATERIAL EXCEPT WASTE NOTED OTHERWISE & IN ACCORDANCE WITH APPLICABLE HAWKINS ACT, 1997 & ALL CURRENT REGULATIONS.
7. MECHANICAL, PLUMBING, &/OR ELECTRICAL CONTRACTORS SHALL BE RESPONSIBLE FOR THE PROTECTION OF ALL EXISTING WORK AND SHALL BE RESPONSIBLE FOR THE PROTECTION OF ALL EXISTING UTILITIES.
8. GENERAL CONTRACTOR RESPONSIBLE FOR CUTTING ALL EXISTING WORK AND SHALL BE RESPONSIBLE FOR THE PROTECTION OF ALL EXISTING WORK AND SHALL BE RESPONSIBLE FOR THE PROTECTION OF ALL EXISTING UTILITIES.

RICE CONTRACTING LTD.
 PROJECT MANAGERS - GENERAL CONTRACTORS
 100 SALISBURY ROAD
 NEW BRUNSWICK
 TEL: 081 491 1822
 FAX: 081 491 1823

BA BOMA ARCHITECT LTD
 35 Cedar Grove
 Drive
 Scarborough, New Brunswick
 Tel: 506 849-8970
 Fax: 506 847-7986
 email: baromab@boma.com

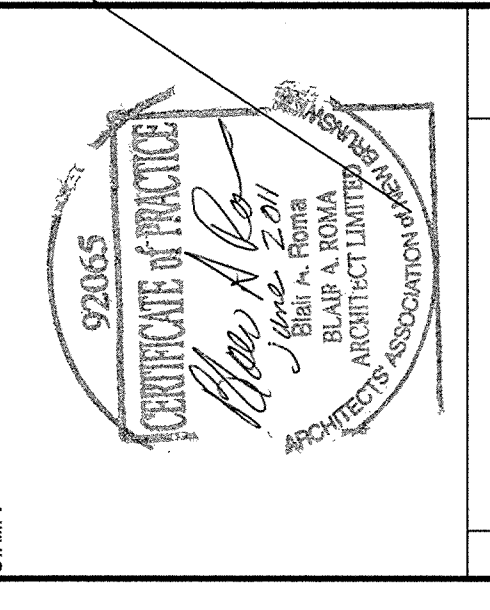

NO.	REVISION	DATE

CLIENT: RICE CONTRACTING LTD.
 MONCTON NEW BRUNSWICK

PROJECT: ST. ANDREWS PRESBYTERIAN CHURCH
 DIEPPE NEW BRUNSWICK

TITLE: MAIN FLOOR PLAN

DRAWN BY: JON PITMAN	DATE: JUNE 21, 2010
CHECKED BY: AUBA A. ROMA	SCALE: 1/8"=1'-0"
PROJECT NO: 0815-SCH10-A2-F.P.	JOB REF: 107-1-C
REV. NO: 10	REV. DATE: MAY 31, 2011

A2.1

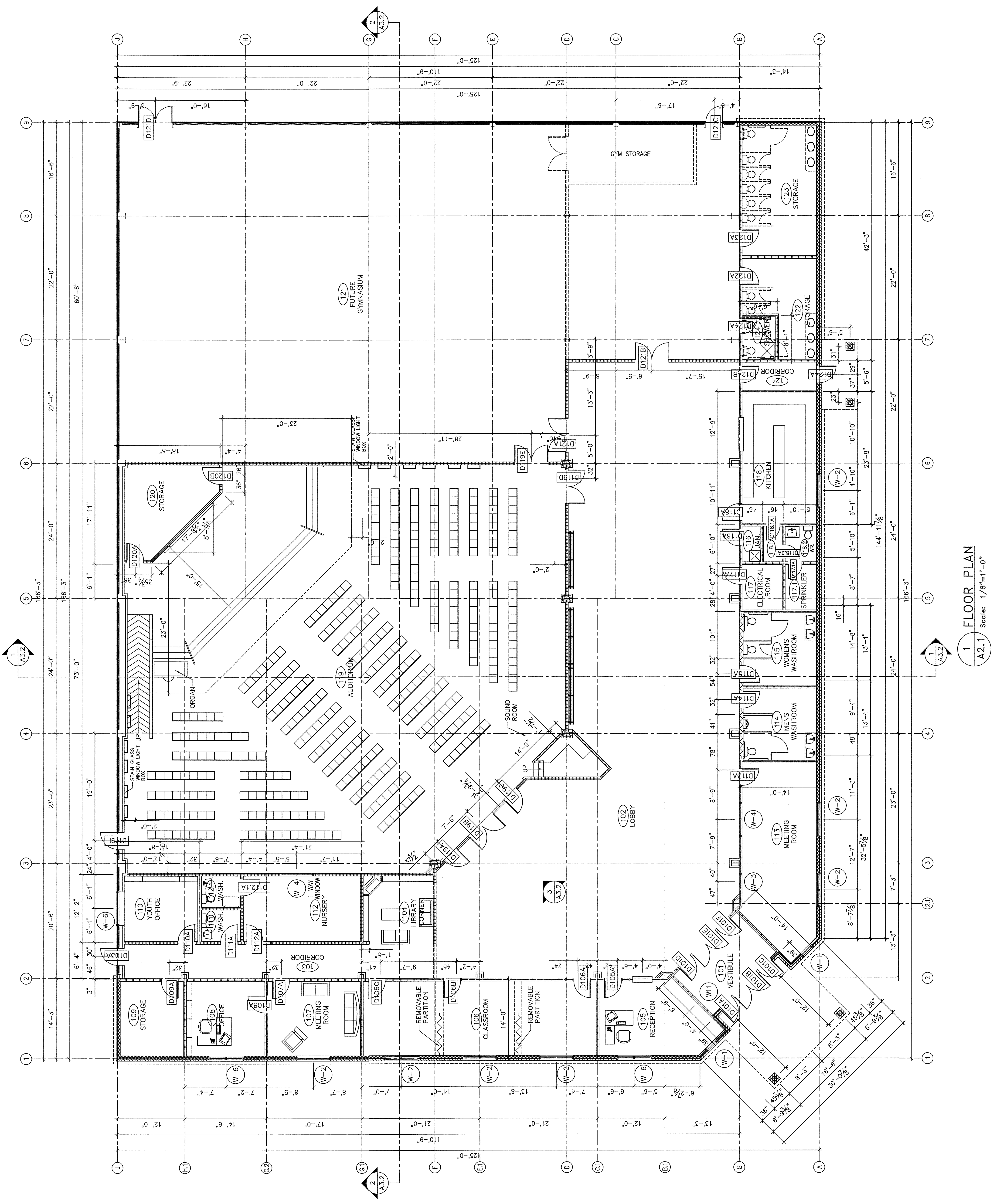

1 FLOOR PLAN
 A2.1 Scale: 1/8"=1'-0"